

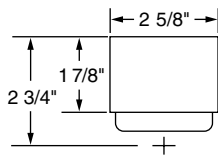

**Striplite Series** is ideal for general purpose lighting in retail stores and commercial environments. Available in 2', 3', and 4' individual lengths as well as continuous row mounting.



CHT



**Dimensions**

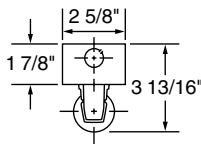

**Housing**

Die-formed heavy 20 gauge steel with high-gloss, baked white enamel finish over rust inhibiting phosphate coat with removable wireway access panel. Ample knockouts provided on side, back and ends. Shipped fully wired and assembled, including socket saddle. Simply attach wireway cover with turn fastener provided.

**Options**

Modular wiring and emergency lighting battery packs are available options.

**Electrical**

Fully wired for UNV 120-277V, 50-60Hz operation with thermally protected, automatic resetting Class P, sound rated A ballast as standard unless otherwise specified (except slimline and HO models). UL listed damp location.

**Mounting**

Optional plug-in wiring system described in detail on page 92.

**CH 20 Gauge Striplite Ordering Information**

Series	# Lamps	Lamps		ELS Options
CH	1	15 = 15W 18" T8	32 = 32W 48" T8	ELS1 = Emergency Lighting (low lumens) ELS2 = Emergency Lighting (medium lumens) ELS3 = Emergency Lighting (high lumens)
	2	17 = 17W 24" T8	40TT = 40W 22" TT	
	21 = Tandem, two lamps	25 = 25W 36" T8	54 = 54W T5HO	
	22 = Tandem, four lamps			

Ballast	Switching	Voltage	Housing
B11 = Electronic T8 B11HP(x) = HPT8* B12 = Electronic T5 B14 = Electronic TT	For 4 lamp units Blank = dual ballasts 4L = (1) 4-lamp ballast  For 2 lamp units Blank = single ballast 2/1L = (2) 1-lamp ballasts	UNV = 120-277V 120 = 120V 277 = 277V	20GA = 20 Gauge

\*CEE listed T8; specify (L)ow, (N)ormal, or (H)igh ballast factor. Contact factory for NEMA Premium.

Options	Accessories
<b>Cord and Plug</b> CPT(x) 1 = 120V 2 = 277V CP3 = Cord & Plug - 120V Straight Blade 5-15P  <b>PLUG-IN CONNECTORS</b> Ballast wired to Black: PL1 - one circuit, two wires PL2 BK - two circuits, three wires Ballast wired to Red: PL2 RD - two circuits, three wires	CA24 = Chain Hanger Assembly - (2) 18" chains, (2) "V" hooks, (2) "S" hooks for total drop 24" CS24 = "S" Hook (4) Chain Hanger Assembly (24" total drop) PM(x) = Pendant Mount, white stem - specify length in inches (24, 36, 48, 60, 72) C = Single white canopy (for use with pendant mount) SN = Snapper Brackets  <b>Wire Guards</b> WG(x)20 = 24" (Specify # Lamps) (1 or 2) WG(x)30 = 36" (Specify # Lamps) (1 or 2) WG(x)40 = 48" (Specify # Lamps) (1 or 2)