

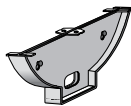

**LDI Linear Direct/Indirect fixtures** have a bold, yet practical, look ideal for commercial environments and schools. One-piece housing ensures no sagging. Time saving "keyhole" end plate design for lift and slide continuous row installation. Electronic ballast saves energy and has no hum and no flicker.

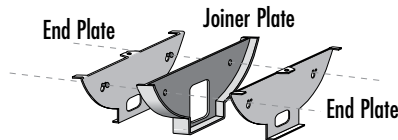

**Linear Row Mounting**



**Dimensions**

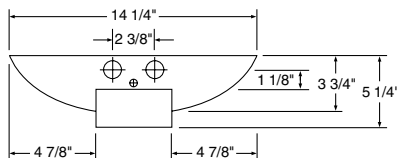

**Housing**

One-piece steel housing with high-gloss, baked white enamel finish over rust inhibiting phosphate coat. Continuous row end plates designed for easy linear mounting.

**Reflector**

Perforated housing with translucent milk white acrylic overlay allows ambient light distribution. Individually mounted units supplied with formed plastic end plates that will not fade or discolor.

**Electrical**

Fully wired for UNV 120-277V, 50-60Hz operation with thermally protected, automatic resetting Class P, sound rated A electronic ballast as standard unless otherwise specified. UL listed.

**Mounting**

Individual or continuous row pendant mount with aircraft cable or stem/canopies. Continuous row fixtures include joiner plate to eliminate light leak, order LDJJP and LDIEC separately. Row units available in 4' and 8' increments only.

**LDI Series Ordering Information**

Series	Lamps	Options
<b>LDI</b>	<b>232</b> = (2) 32W 48" T8	<b>ELS1</b> = Emergency Lighting (low lumens)
<b>LDII</b> = individual with 2 end caps	<b>254</b> = (2) 54W 48" T5HO	<b>ELS2</b> = Emergency Lighting (medium lumens)
	<b>2232</b> = (4) Tandem 32W 48" T8	<b>ELS3</b> = Emergency Lighting (high lumens)
	<b>2254</b> = (4) Tandem 54W 48" T5HO	

Ballast	Voltage	Accessories
<b>B11</b> = Electronic T8	<b>UNV</b> = 120-277V	<b>LDJJP</b> = Linear Direct/Indirect Joiner Plate, order one less than number of fixtures.
<b>B11HP(x)</b> = HPT8*		<b>LDIEC</b> = Linear Direct/Indirect End Cap, order 1 pair for each row.
<b>B12</b> = Electronic T5		<b>LDIPM(x)**</b> = Pendant Mount Kit, includes 2 white stems, mounting brackets and canopies - specify length in inches ( <b>24, 36, 48, 60, 72</b> )
		<b>CACC(x)**</b> = Cable Kit, includes 2 cables, mounting hardware, white power cord and canopies; specify length in inches ( <b>48</b> or <b>72</b> )

\*CEE listed T8; specify (L)ow, (N)ormal, or (H)igh ballast factor. Contact factory for NEMA Premium.

\*\*Requires 1 Pendant Mount or Cable Kit per 4' or 8' tandem unit