

# TECHNICAL SPECIFICATIONS

CATALOG NUMBER \_\_\_\_\_  
 TYPE \_\_\_\_\_  
 DATE \_\_\_\_\_  
 PREPARED BY \_\_\_\_\_  
 PROJECT \_\_\_\_\_

## CH Residential strip light

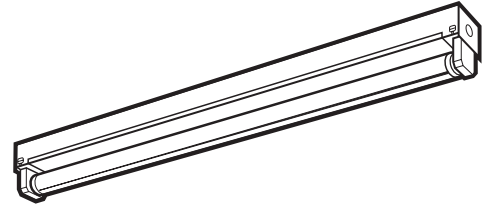

**HOUSING:** Die-formed heavy gauge steel with high-gloss, baked white enamel finish over rust inhibiting phosphate coat with removable wireway access panel. Ample knockouts provided on side, back and ends. Shipped fully wired and assembled, including socket saddle. Simply flip up socket bar and attach wireway cover with turn fastener provided. Machine installed shunts eliminate loose socket bar connections on electronic strips.

**ELECTRICAL:** Fully wired for UNV 120-277V, 50-60Hz operation with thermally protected, automatic resetting Class P, sound rated A ballast as standard unless otherwise specified. UL listed damp location.

### CH Strip Lights Ordering Information

Series	# Lamps	Lamp Type	Ballast	Voltage
CH	1	14 = 14W 15" T12	B11 = Electronic T8	UNV = 120-277V
	2	15 = 15W 18" T8/T12	B5 = Electronic T12	120 = 120V
	21 = Tandem, two lamps	17 = 17W 24" T8	B14 = Electronic TT	277 = 277V
	22 = Tandem, four lamps	20 = 20W 24" T12	B22 = LPF T8/T12 120V	
		25 = 25W 36" T8		
		30 = 30W 36" T12		
		32 = 32W 48" T8		
		40 = 34/40W 48" T12		
		40TT = 40W 22" TT		

Commercial options and accessories also available.

### Dimensions

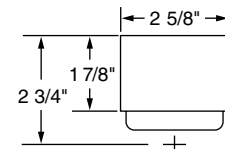

CHTT

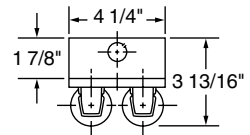
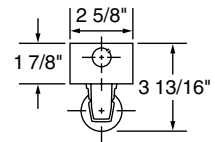

CH