

# TECHNICAL SPECIFICATIONS

## SMCW Residential wall cloud

CATALOG NUMBER \_\_\_\_\_  
TYPE \_\_\_\_\_  
DATE \_\_\_\_\_  
PREPARED BY \_\_\_\_\_  
PROJECT \_\_\_\_\_



**HOUSING:** Die-formed heavy gauge steel with high-gloss, baked white enamel finish over rust inhibiting phosphate coat.

**SHIELDING:** Frameless white acrylic diffuser with D.R. for added durability and even efficient illumination. SMCW model uses brass caps to hold diffuser in place.

**ELECTRICAL:** Fully wired for UNV 120-277V, 50-60Hz operation with thermally protected, automatic resetting Class P, sound rated A ballast as standard unless otherwise specified. UL listed.

**MOUNTING:** Wall mounting.

### SMCW Ordering Information

Series	Lamps	Ballast	Voltage
SMCW	217 = (2) 17W 24" T8	B11 = Electronic T8	UNV = 120-277V
	225 = (2) 25W 36" T8	B22 = LPF T8/T12 120V	120 = 120V
	232 = (2) 32W 48" T8		

### Dimensions

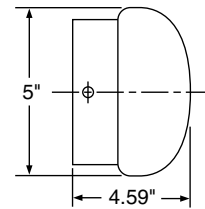

SMCW fixtures are available in 27", 39" and 51" models.