

WEC Bath Bars

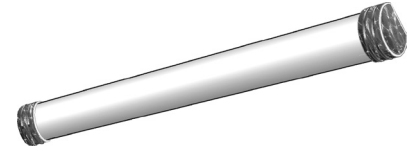

CATALOG NUMBER _____
 TYPE _____
 DATE _____
 PREPARED BY _____
 PROJECT _____

HOUSING: Die-formed heavy gauge steel with high-gloss, baked white enamel finish over rust inhibiting phosphate coat. Knockouts provided on back.

DIFFUSER: Consists of a UV acrylic clear ribbed, white ribbed, or smooth white lens, mated to one of a variety of end caps. The end caps are available in wide and narrow versions in a range of colors and textures. Diffuser is secured to housing with spring clips. ADA Compliant.

ELECTRICAL: Fully wired for UNV 120-277V, 50-60Hz operation with thermally protected, automatic resetting Class P, sound rated A ballast as standard unless otherwise specified. UL listed.

MOUNTING: Surface mount wall or ceiling, vertical or horizontal.

WEC Series Ordering Information

Series	Size	Color	Diffuser
WECN = 1/2" end cap	2 = 25.5"	AL = Alabaster	CR = Clear ribbed
WECW = 1 1/2" end cap	3 = 37.5"	BW = Bone White	WR = White ribbed
	4 = 49.5"	IV = Ivory Marble	WS = White smooth
		PM = Peach Marble	
		SW = Solid White	
		TO = Tortoise	
		VG = Verde Green	
		WM = White Marble	

Trim	Lamps	Ballast	Voltage
B = Brass (WECW only)	217 = (2) 17W 24" T8	B11 = Electronic T8	UNV = 120-277V
C = Chrome (WECW only)	225 = (2) 25W 36" T8	B22 = LPF T8/T12	120 = 120V
N = None	232 = (2) 32W 48" T8		

Dimensions

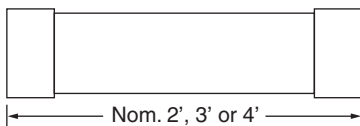

WECW - 1 1/2" endcap

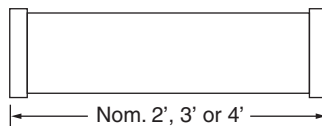

WECN - 1/2" endcap

