

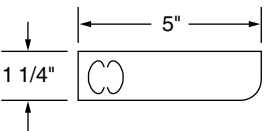

UW Task Lighting provides uniform, efficient illumination. UW series is shipped with outlet and turn switch, optional cord and plug available.

Dimensions

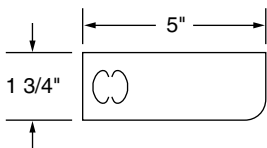
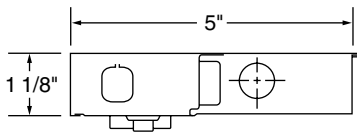

Housing

Heavy gauge steel with flush ends. KOs provided top, side and back. Baked white enamel over rust inhibiting phosphate coat, white interior.

Shielding

Snap-in D.R. acrylic diffuser for longer life and less breakage. Ribbed linear prisms for even light distribution. Translucent milk white is standard.

Options

White grounded 6' cordset, grounded convenience outlet, cool white lamp included, and rocker switch are available options.

Electrical

Fully wired for 120V, 50-60Hz operation with thermally protected, automatic resetting Class P, sound rated A ballast as standard unless otherwise specified. UL listed.

Mounting

Individual or continuous rows.

UW Task Lighting Ordering Information

Series	Lamps	Ballast	Voltage
UW	117 = (1) 17W 24" T8	B11 = Electronic T8	UNV** = 120-277V
	125 = (1) 25W 36" T8	B11HP(x) = HPT8*	120 = 120V
	132 = (1) 32W 48" T8	B22 = Electronic T8/T12 LPF	
	20 = 20W 24" T12		
	30 = 30W 36" T12		

*CEE listed T8; specify (L)ow, (N)ormal, or (H)igh ballast factor. Contact factory for NEMA Premium.

**UNV only available when unit is less outlet and switch

Options

- Standard with outlet and turn switch.
- LA** = Less outlet and turn switch
- C** = 120V 6' white 3-wire cord and plug
- RSW** = 120V Rocker switch
- LCO** = Less convenience outlet
- LSW** = Less turn switch