

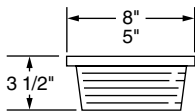

V4000 marine Grade A aluminum housing keeps out moisture, preventing rust, and also promotes longer lamp life and longer ballast life due to better heat dissipation and cooler operating temperatures. High abuse fluorescent fixture for T8 available in two lamp models.

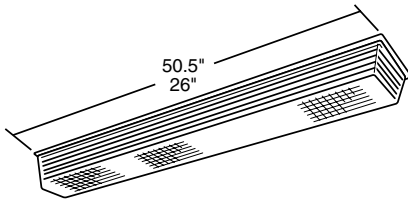

Dimensions



with Back Box

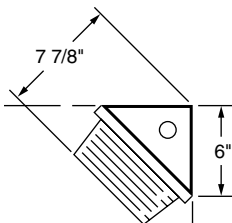

Corner Box

Housing

Marine Grade A, heavy-gauge aluminum with gasketing for maximum corrosion resistance, offered with optional back boxes. Models with painted parts receive high-gloss baked enamel applied after pre-treatment to ensure superior paint adhesion and rust resistance. Fixtures have white housing.

Shielding

High-impact, UV Treated, multipatterned polycarbonate for remarkable impact strength.

Electrical

Fully wired for UNV 120-277V, 50-60Hz operation with thermally protected, automatic resetting Class P, sound rated A ballast as standard unless otherwise specified. UL listed, wet location ceiling mount, damp location wall mount.

Mounting

Wall or ceiling, indoor. Corner mount available.

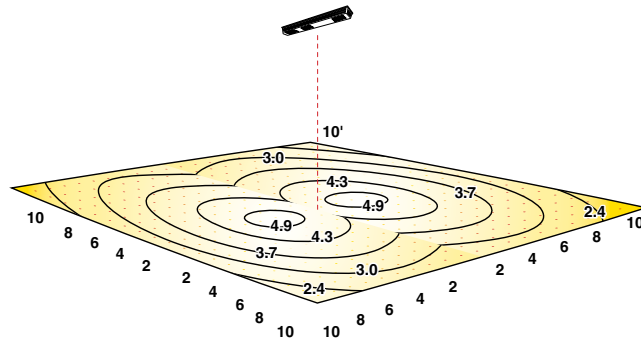

Horizontal Illuminance Analysis: Model V4232 Scale and Surface: .25" to 1' (1' Grid) Units: Footcandles

V4000 Series Ordering Information

Series	Lamp Type	Housing	Ballast
V4	217 = (2) 17W 24" T8	A = Aluminum (standard)	B11 = Electronic T8
VC4 = Vandal Resistant, steel corner box	232 = (2) 32W 48" T8		B11HP(x) = HPT8*

*CEE listed T8; specify (L)ow, (N)ormal, or (H)igh ballast factor. Contact factory for NEMA Premium.

Voltage	Options	Accessories
UNV = 120-277V 120 = 120V 277 = 277V	MS = Maximum security (Tamperproof screws) L1 = Lamps	V401A20 = Aluminum back box for 1/2" conduit for 20W unit V401A40 = Aluminum back box for 1/2" conduit for 40W unit TSD = Tamper-proof screwdriver